

PROTECTIVE BARRIERS  
REMOVED FOR CLARITY

PROTECTIVE BARRIERS  
REMOVED FOR CLARITY

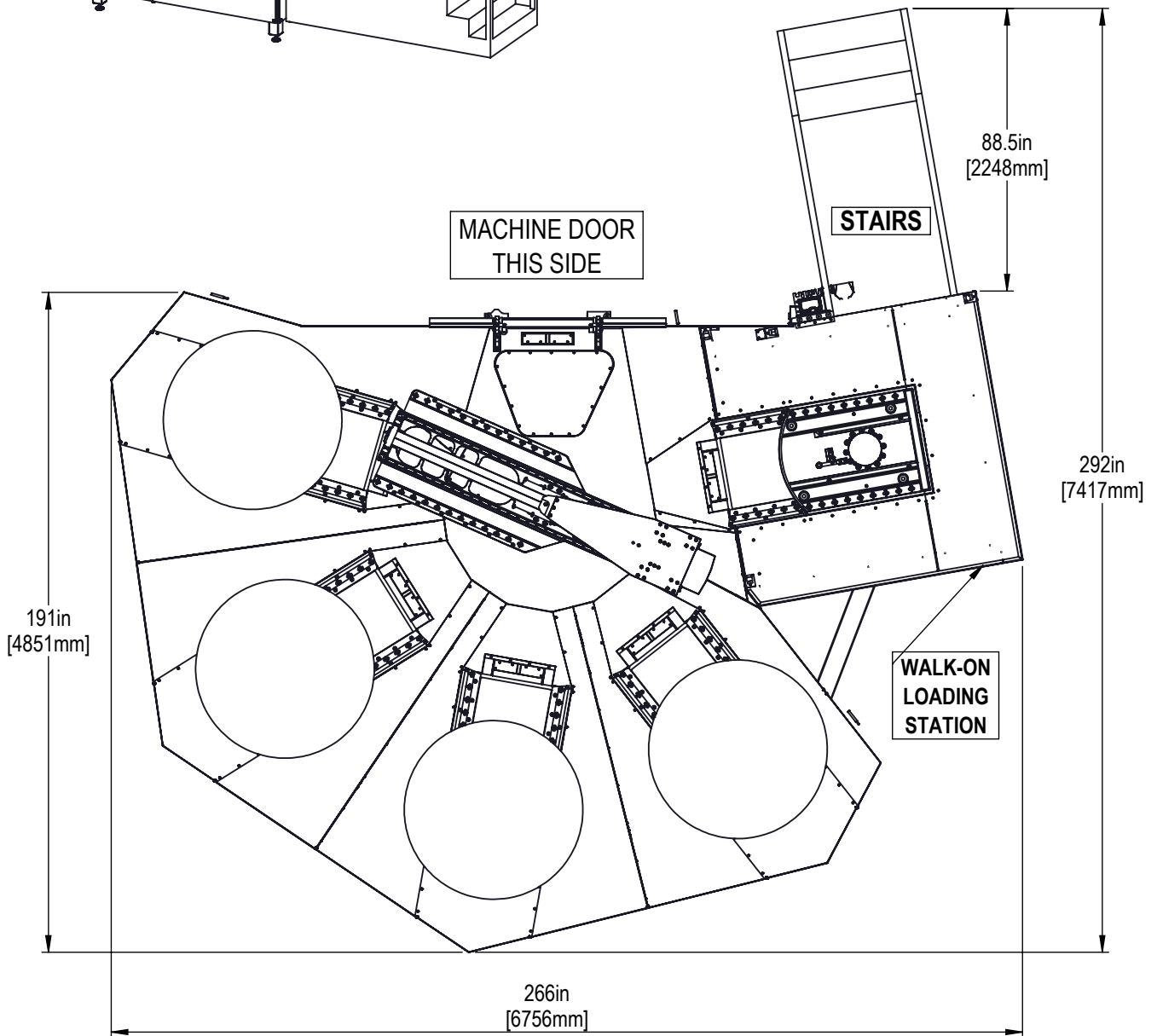

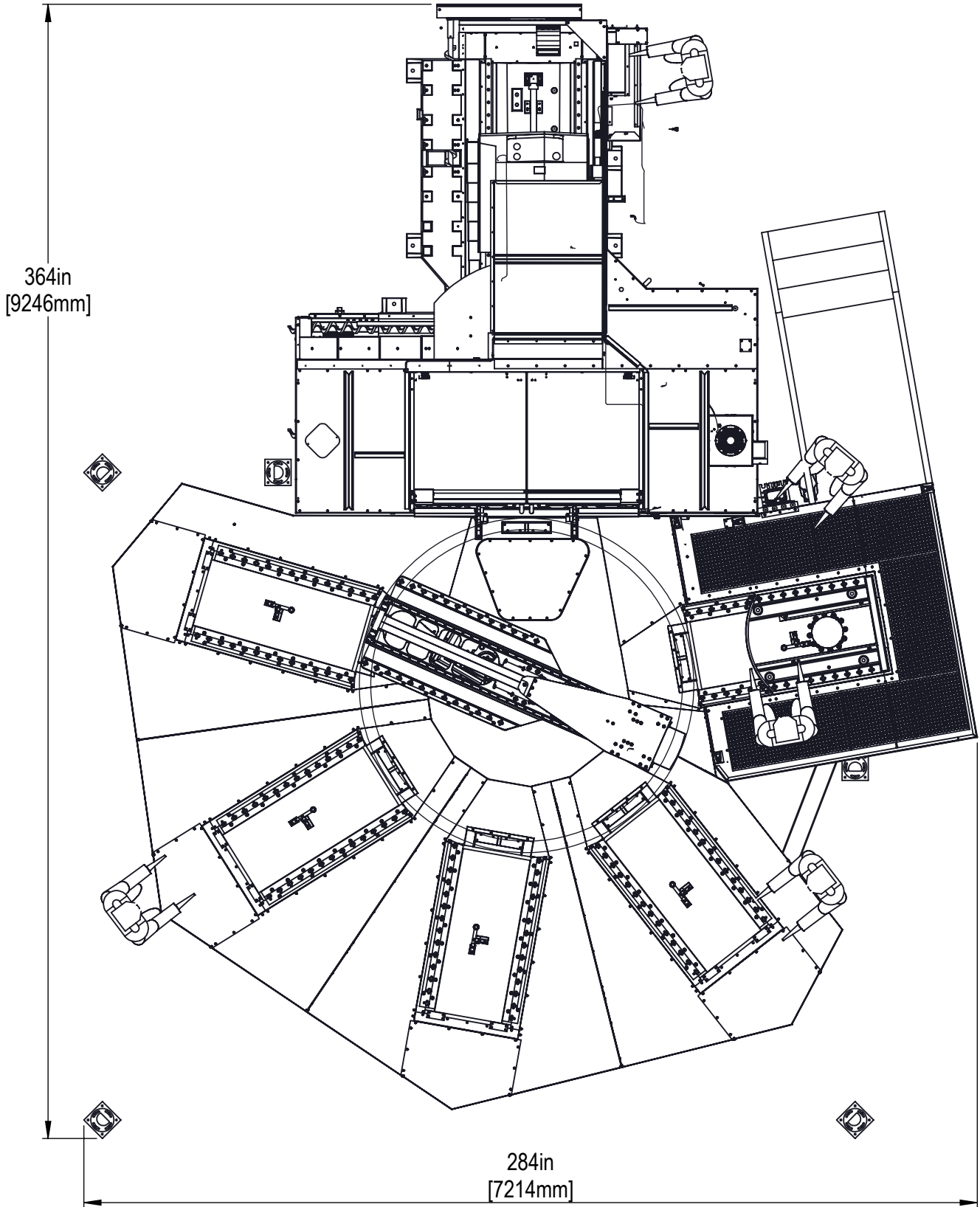

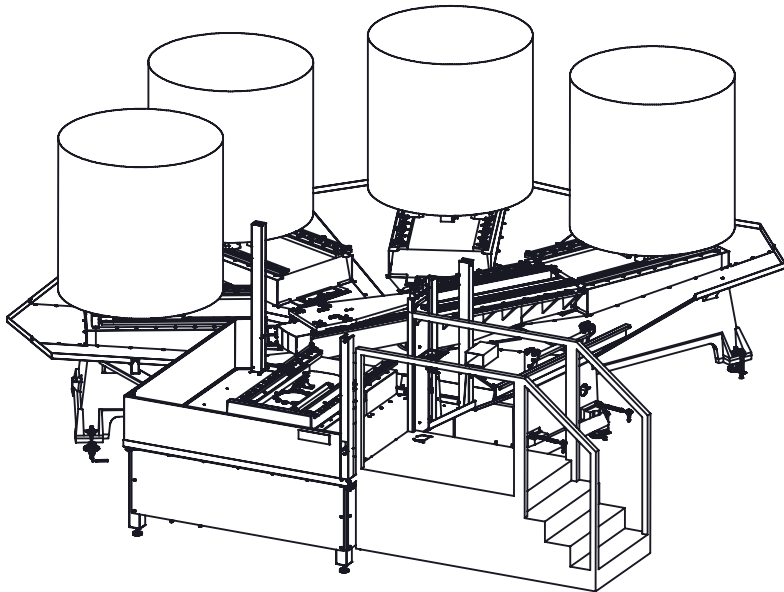

55in [1397mm]  
MAXIMUM DIAMETER

38.8in [986mm]  
MAXIMUM SQUARE

54in [1372mm] MAXIMUM HEIGHT  
FROM TOP OF PALLET FOR ALL PARTS

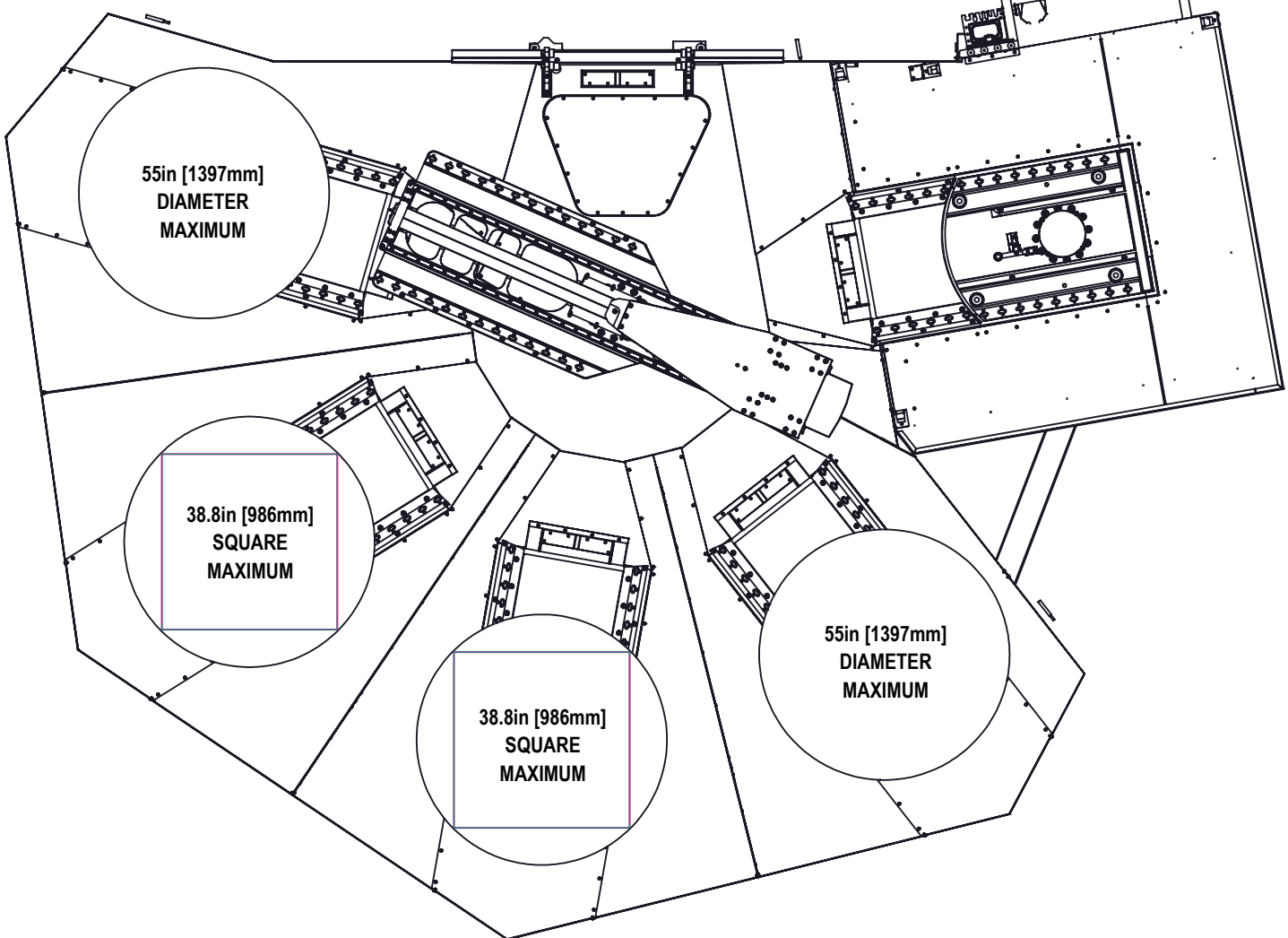

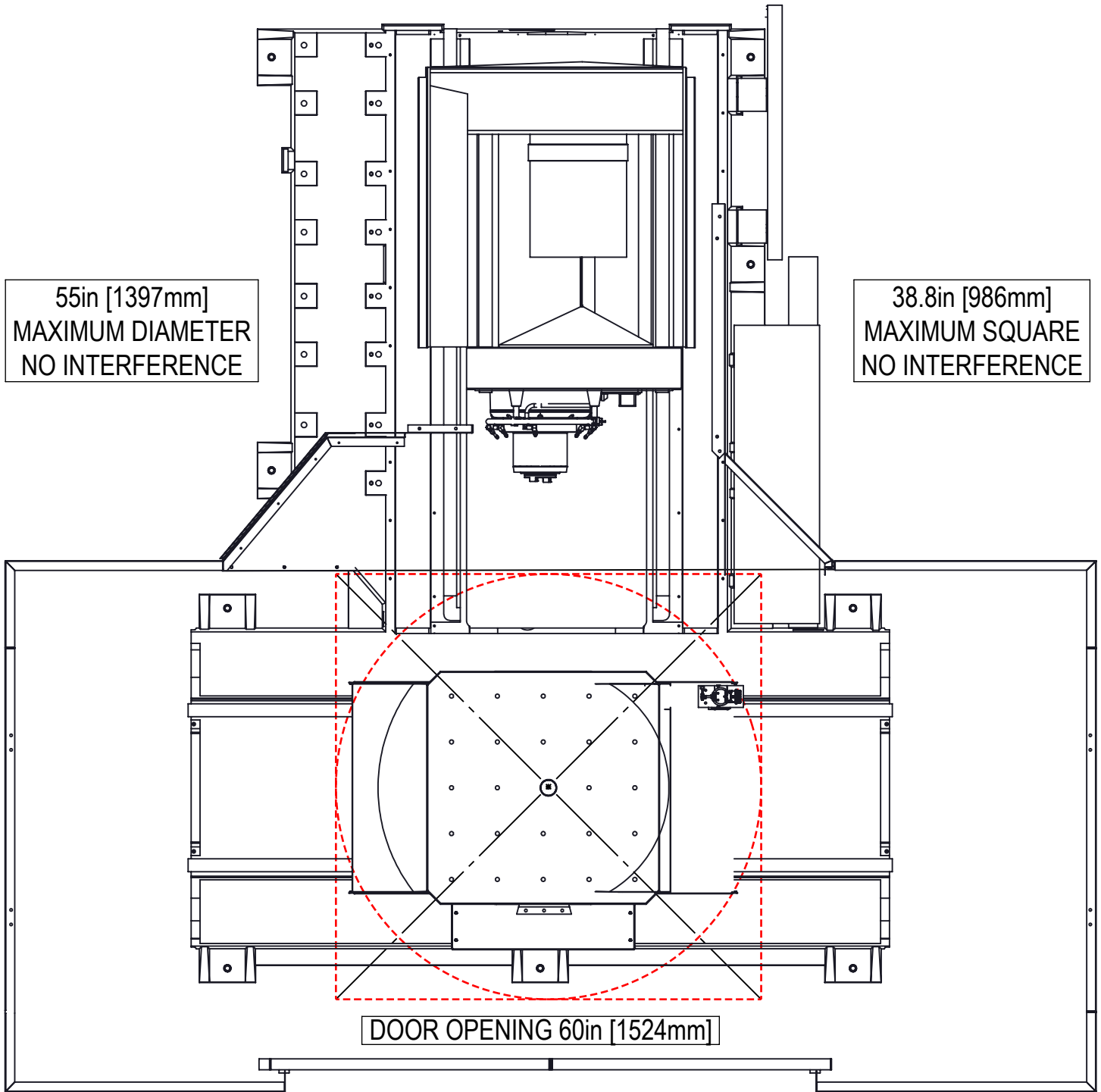

55in [1397mm] DIAMETER PART HAS NO INTERFERENCE WITH ENCLOSURE IN X-AXIS DIRECTION

38.8in [986mm] SQUARE PART HAS NO INTERFERENCE WITH ENCLOSURE IN X-AXIS DIRECTION

**MACHINE MAY NOT BE ZERO RETURNED (ALL-AXIS) WHEN PARTS EXCEED DIMENSIONS ABOVE**

EXAMPLE: 55in [1397mm] SQUARE HAS INTERFERENCE WITH ENCLOSURE IN THE X-AXIS DIRECTION WHEN ROTATING THE PART. "SPECIAL ATTENTION IS REQUIRED"



**160mm GRID PATTERN**

**M16x2.0-6H ∇ 1.26in [32mm] - TAPPED HOLES 25 PLACES**

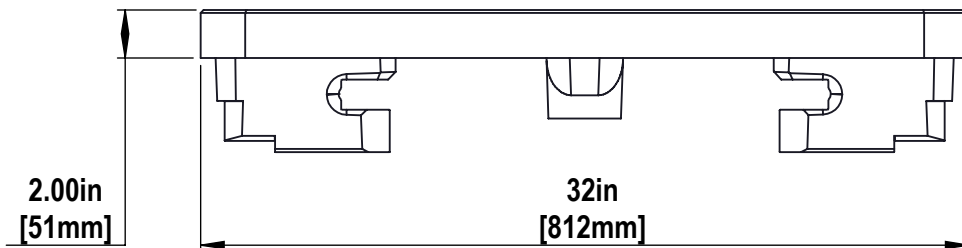
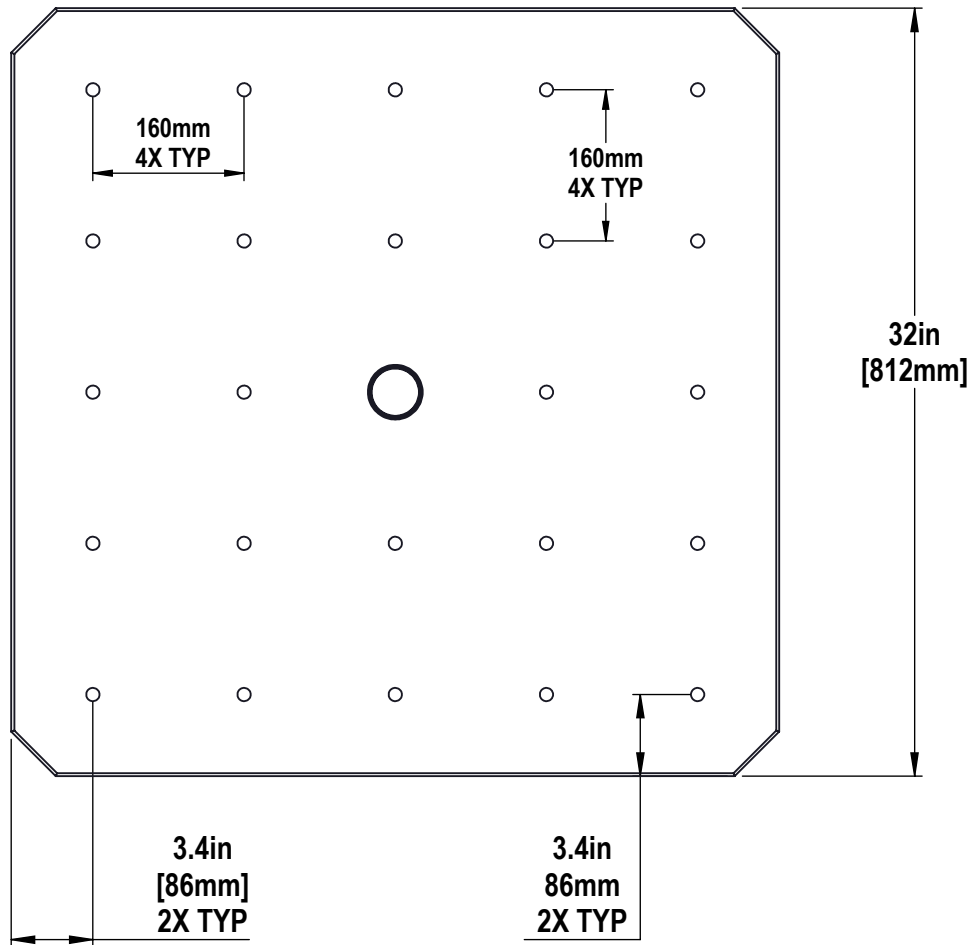

**NO INCH VERSION AVAILABLE**



DRAWING NOT TO SCALE

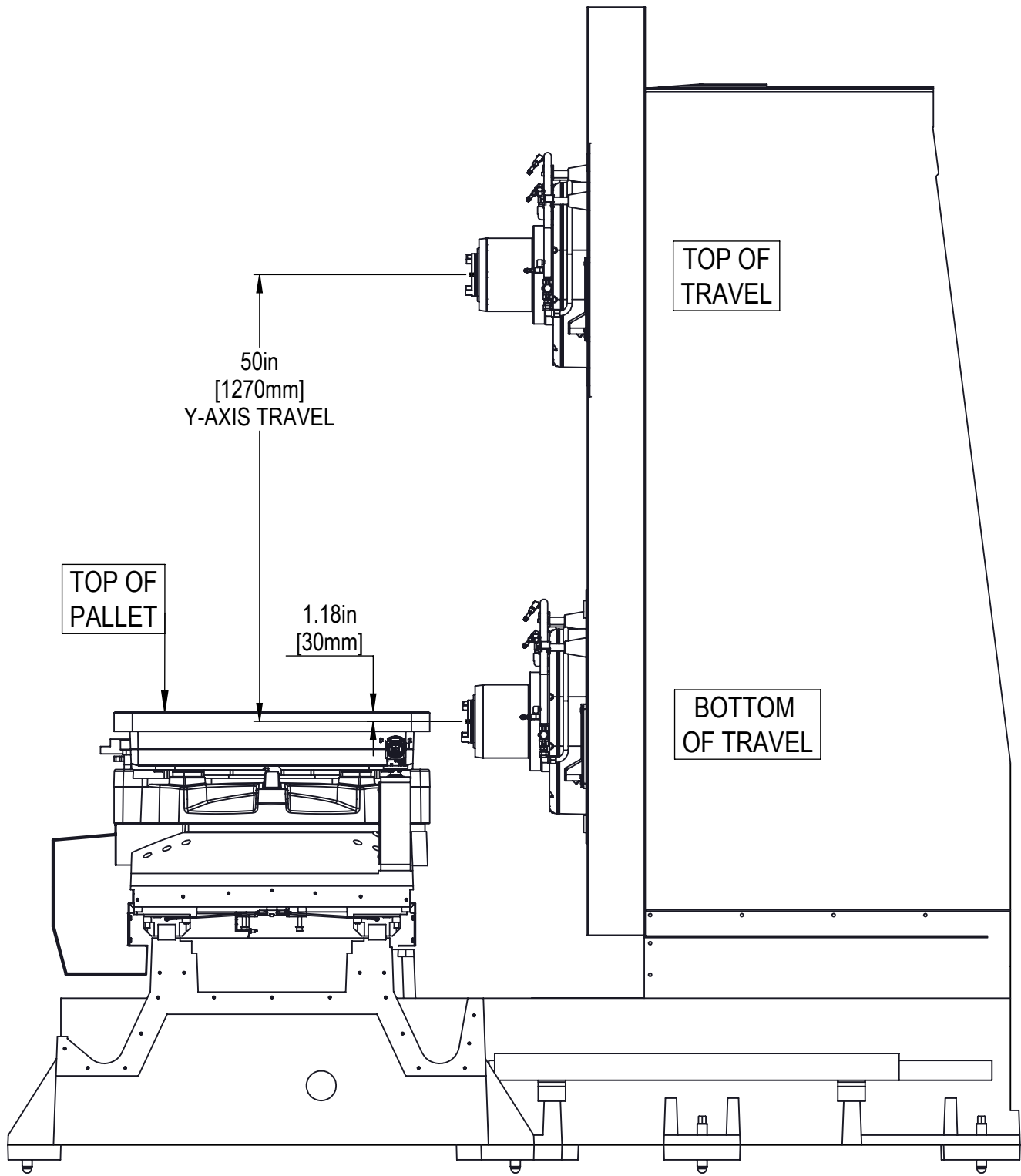

DRAWING NOT TO SCALE

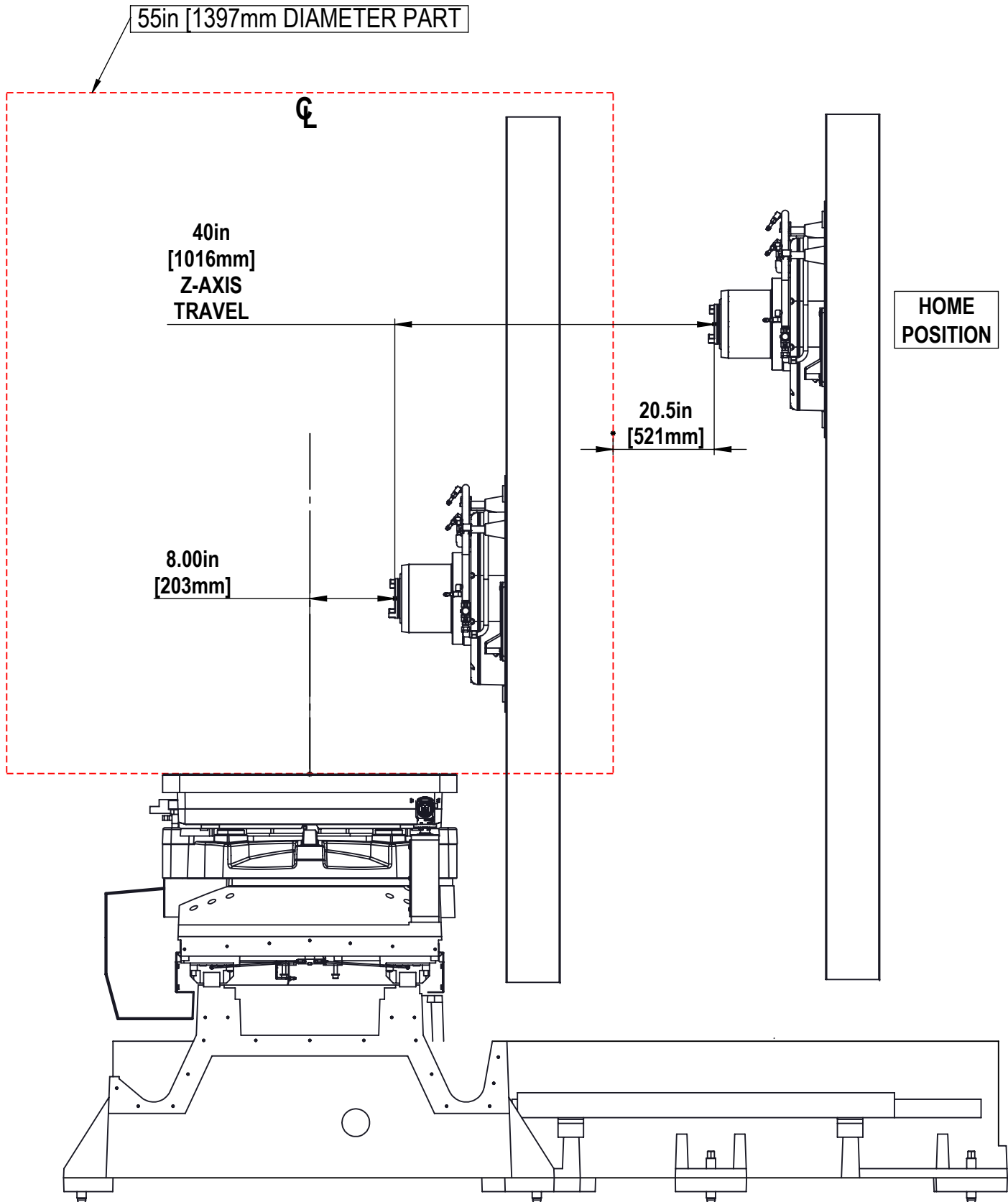

PROTECTIVE COVER OPENS AUTOMATICALLY WHEN PROBE WILL BE USED. REMAINS CLOSED AND PROTECTED WHEN NOT IN USE.

MAXIMUM TOOL DIAMETER PROBING CAPACITY IS 5.00in [127mm]

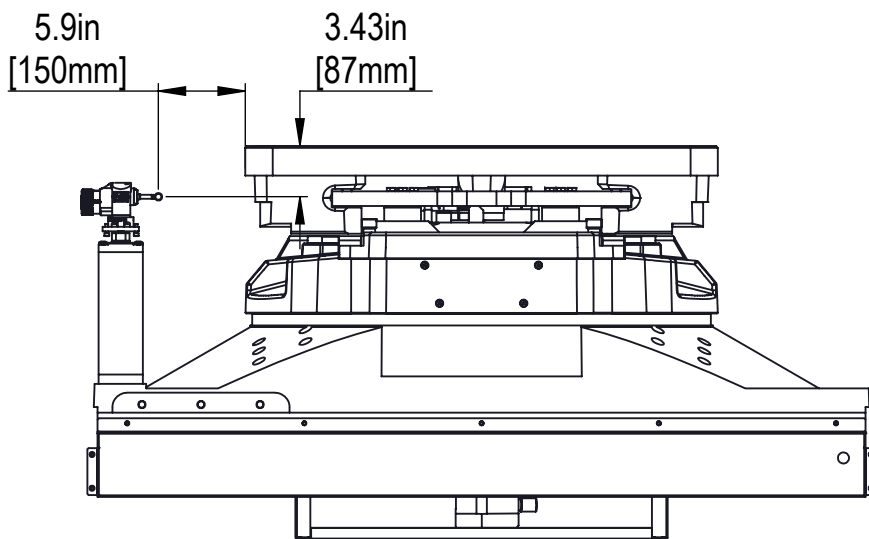
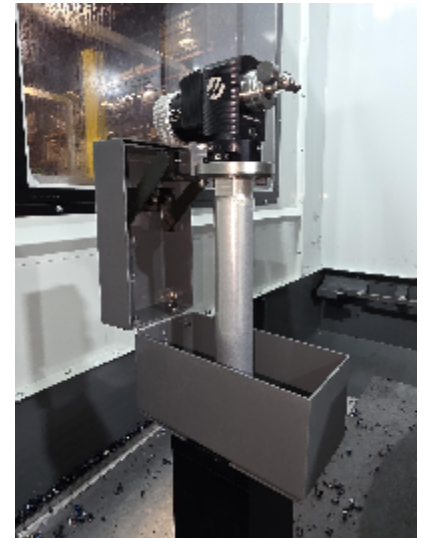

VIEW FROM SPINDLE TOWARDS PALLET

PARTS LARGER THAN  $\phi$  42in [1067mm] DIAMETER OR  $\square$  36in [914mm] SQUARE WILL REDUCE THE TOOL PROBING DIAMETER CAPACITY

$\phi$  42in [1067mm]

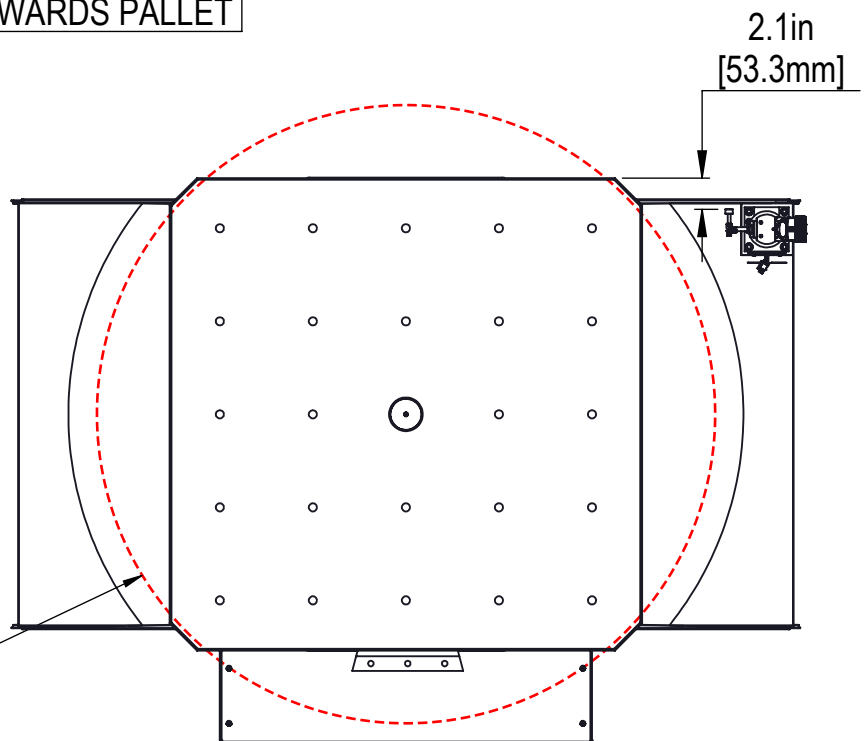

TOP VIEW